

**This electronic collection of documents is provided
for the convenience of the user
and is Not a Certified Document –**

**The documents contained herein were originally issued
and sealed by the individuals whose names and license
numbers appear on each page, on the dates appearing
with their signature on that page.**

**This file or an individual page
shall not be considered a certified document.**

**STATE OF NORTH CAROLINA
 DIVISION OF HIGHWAYS**

PROJ. REFERENCE NO.	SHEET NO.
U-5105	X-0A

NOTE: EMBANKMENT COLUMN INCLUDES BACKFILL FOR UNDERCUT

CROSS-SECTION SUMMARY

Station	Uncl. Exc.	Embt	Station	Uncl. Exc.	Embt
L	(cu. yd.)	(cu. yd.)	Y3	(cu. yd.)	(cu. yd.)
16+90.00000	0	0	10+12.47000	0	0
17+00.00000	53	1	10+25.00000	0	21
17+50.00000	251	7	10+50.00000	0	32
18+00.00000	197	7	10+75.00000	4	14
18+50.00000	278	8	11+00.00000	15	4
19+00.00000	377	17	11+10.00000	7	1
19+50.00000	347	26			
20+00.00000	248	94			
20+50.00000	68	507			
21+00.00000	0	696			
21+50.00000	0	426			
22+00.00000	1	239			
22+50.00000	1	135			
23+00.00000	1	72			
23+50.00000	4	31			
24+00.00000	8	22			
24+50.00000	14	13			
24+90.00000	16	6			
25+55.00000	26	11			
Station	Uncl. Exc.	Embt			
Y1	(cu. yd.)	(cu. yd.)			
16+60.00000	0	0			
17+00.00000	19	30			
17+50.00000	83	54			
18+00.00000	164	44			
18+50.00000	219	38			
19+00.00000	260	24			
19+50.00000	236	3			
20+00.00000	186	20			
20+40.90000	136	29			
Station	Uncl. Exc.	Embt			
Y2	(cu. yd.)	(cu. yd.)			
10+60.14000	0	0			
10+65.00000	0	123			
11+00.00000	0	897			
11+50.00000	0	597			
12+00.00000	0	858			
12+50.00000	0	642			
13+00.00000	3	597			
13+50.00000	10	523			
14+00.00000	10	471			
14+50.00000	13	422			
15+00.00000	15	366			
15+50.00000	5	253			
16+00.00000	30	127			
16+50.00000	33	58			
17+00.00000	2	41			
17+50.00000	4	24			
17+85.00000	10	3			

STATE OF NORTH CAROLINA
DIVISION OF HIGHWAYS

CROSS SECTION SHEET INDEX

- L -	X - 1 THRU X - 4
- Y1 -	X - 4 THRU X - 7
- Y2 -	X - 8 THRU X - 11
- Y3 -	X - 12 THRU X - 13

8/23/99

0 5 10	PROJ. REFERENCE NO.	SHEET NO.
	U-5105	X-1

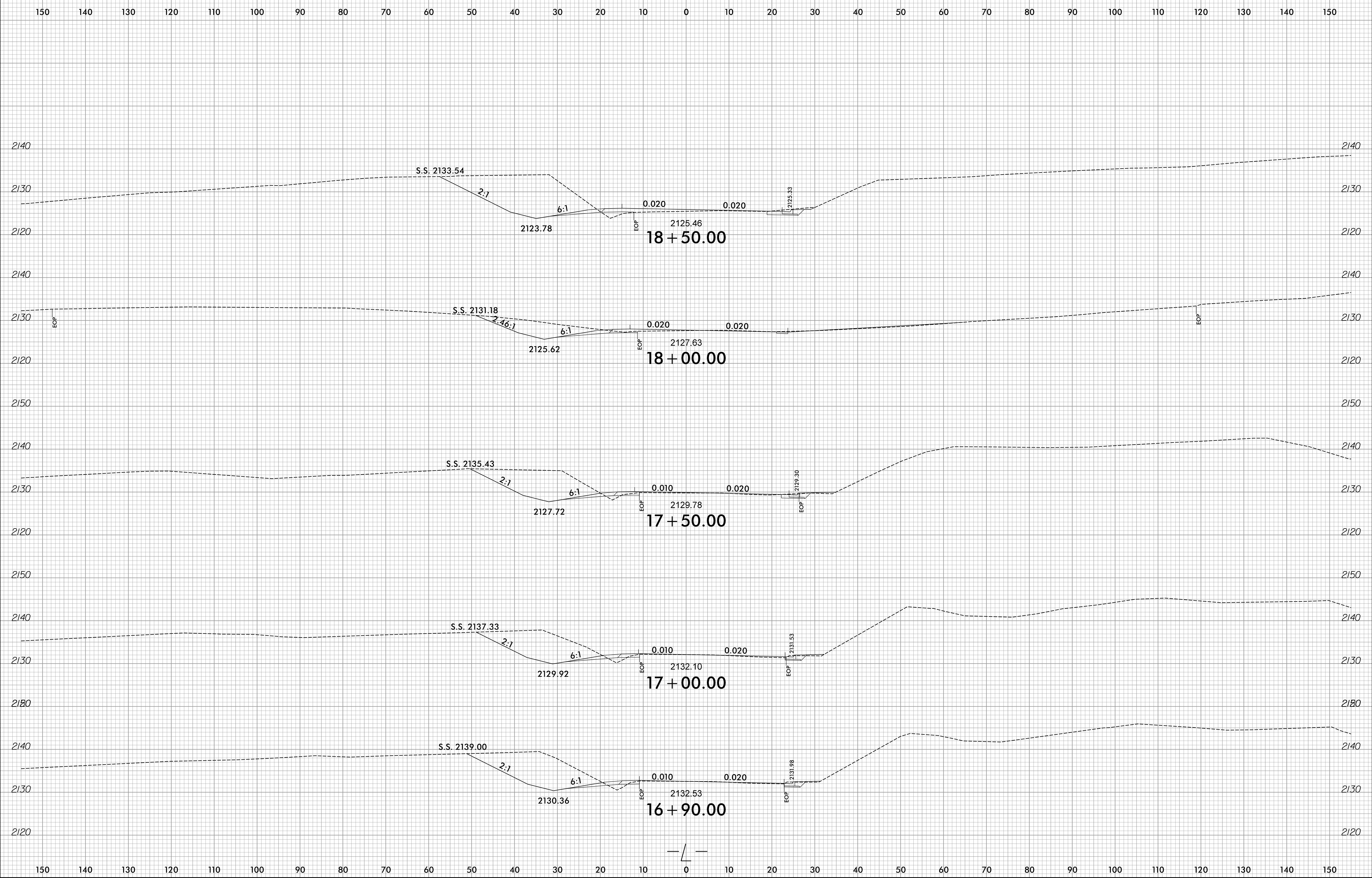

2/14/2018
R:\Roadway\XSC\U5105_r.dwg - xpl.L.dgn
gwilliamson

8/23/99

0 5 10	PROJ. REFERENCE NO.	SHEET NO.
	U-5105	X-2

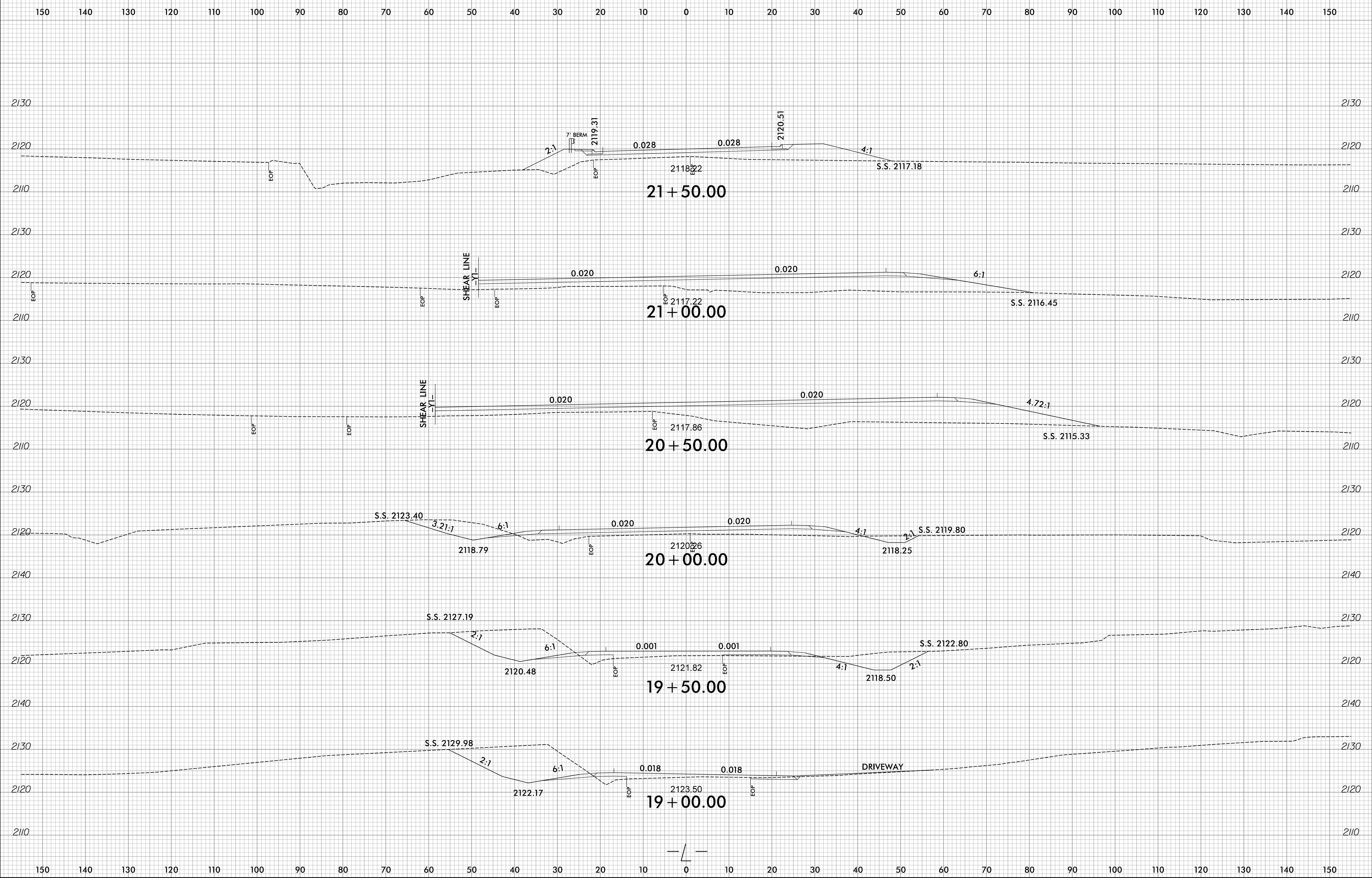

2/14/2018
R:\Roadway\XSC\U5105_r.dwg -xp1.L.dgn
awilliamson

8/23/99

0 5 10	PROJ. REFERENCE NO.	SHEET NO.
	U-5105	X-3

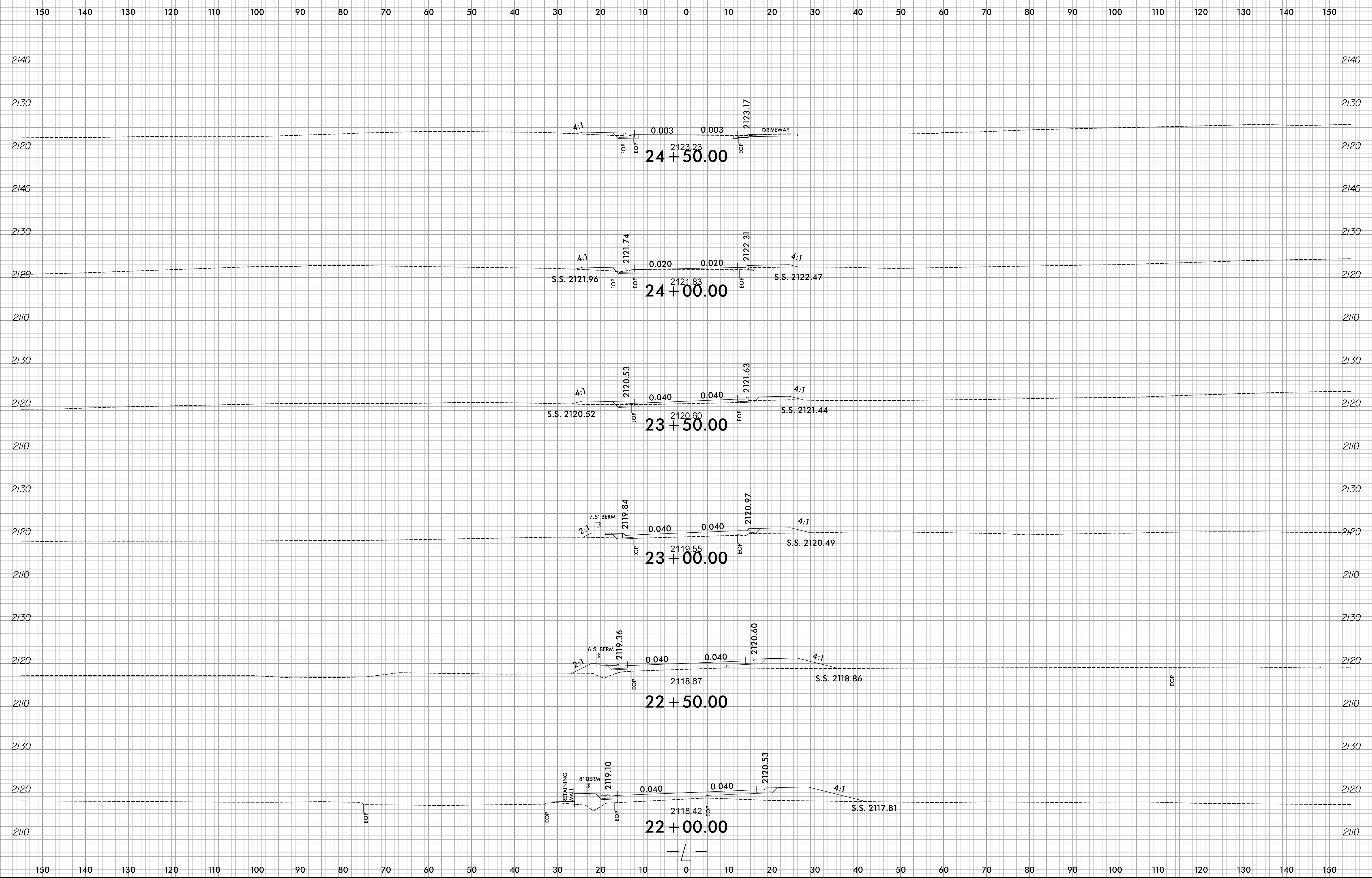

2/14/2018
R:\Roadway\XSC\U5105_r.dwg -xp1.L.dgn
Williamson

8/23/99

0 5 10	PROJ. REFERENCE NO.	SHEET NO.
	U-5105	X-4

150 140 130 120 110 100 90 80 70 60 50 40 30 20 10 0 10 20 30 40 50 60 70 80 90 100 110 120 130 140 150

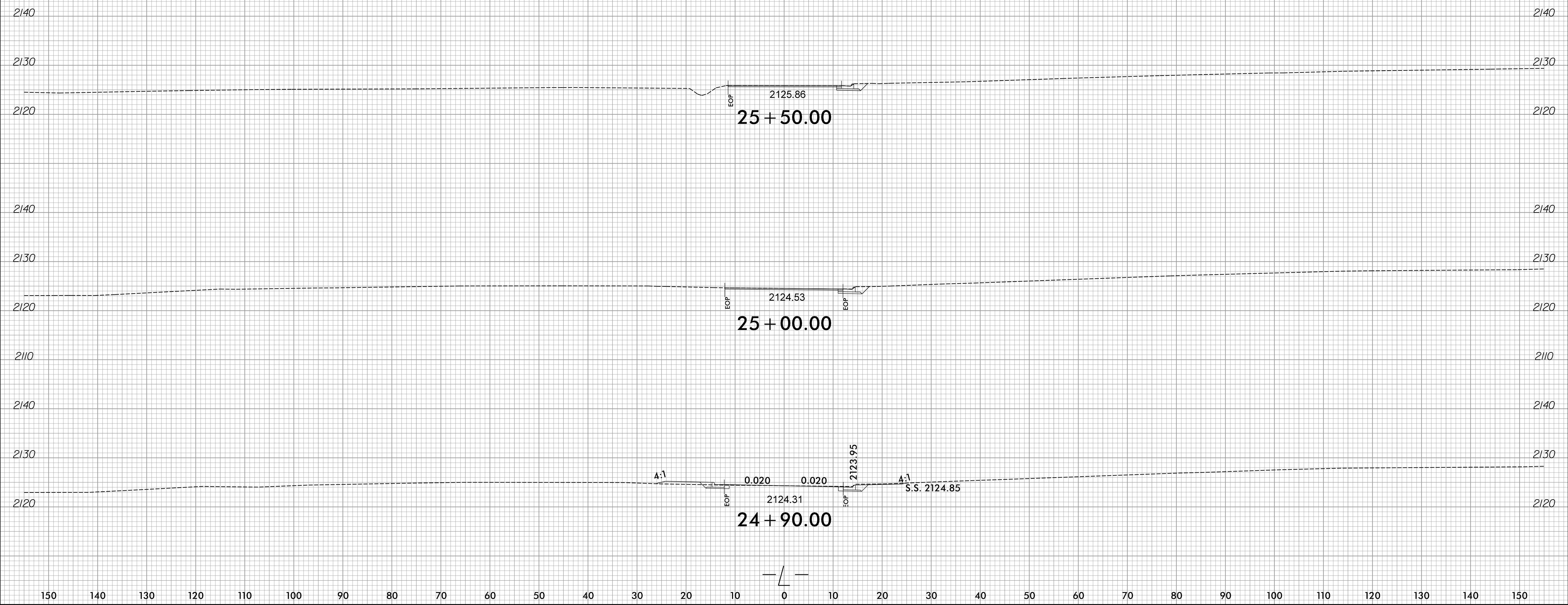

2/14/2018
R:\Roadway\XSC\U5105_r.dwg - xpl.L.dgn
gwilliams

8/23/99

0 2.5 5	PROJ. REFERENCE NO.	SHEET NO.
	U-5105	X-5

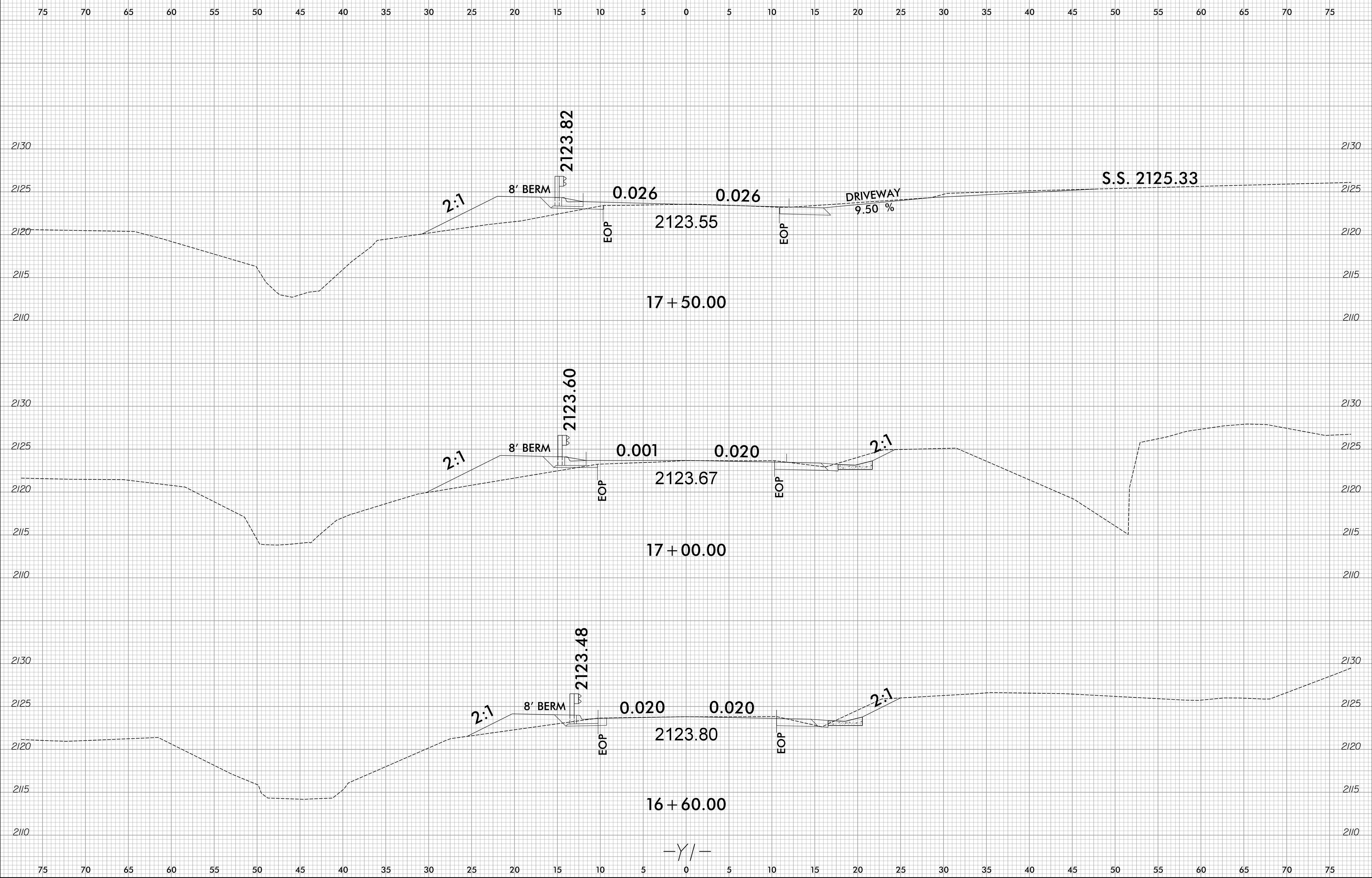

2/14/2018
R:\Roadway\XSC\U5105_r.dwg -xp1_Y1.dgn
Bill Hanson

-Y/-

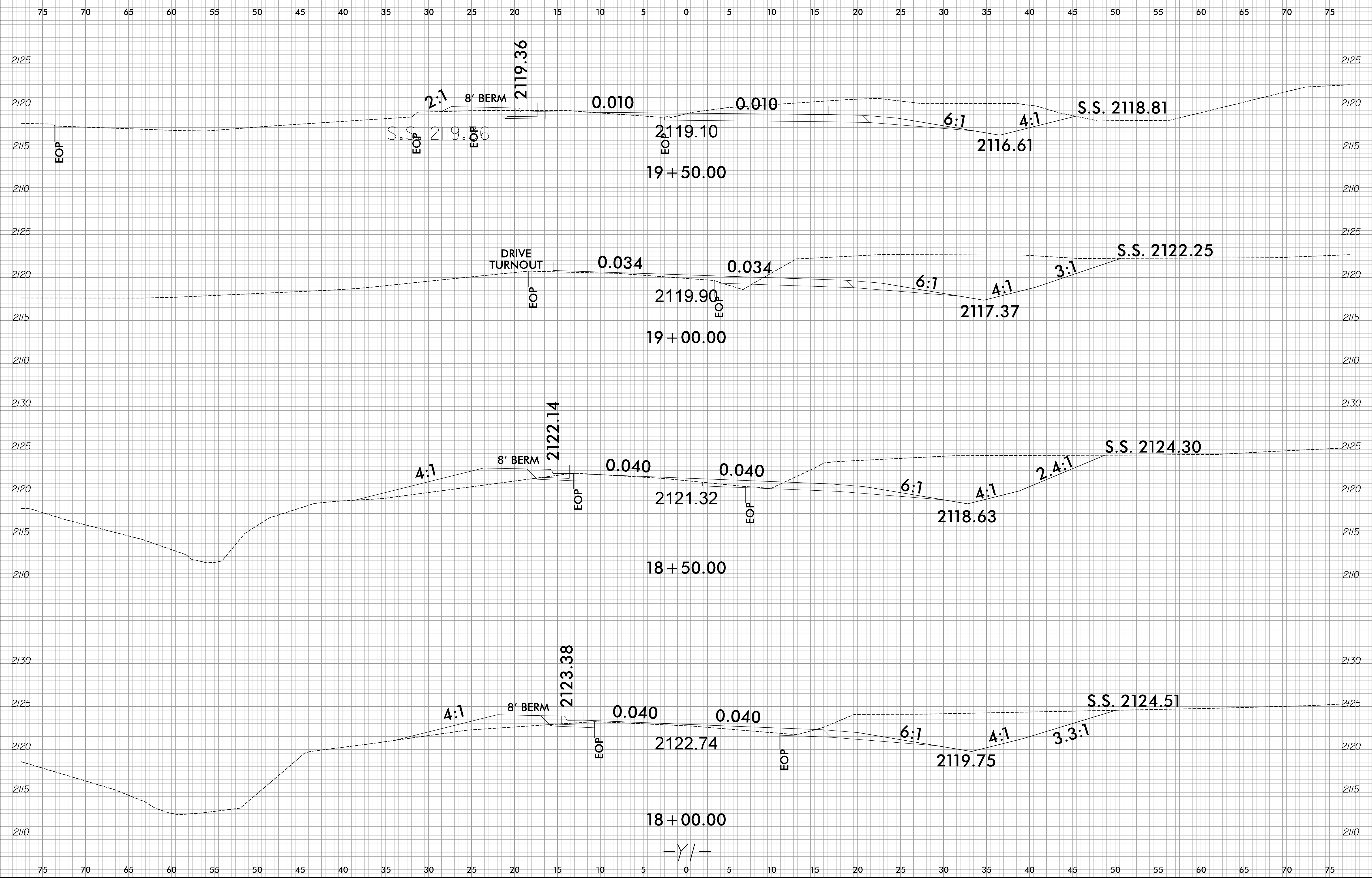

8/23/99

0 2.5 5	PROJ. REFERENCE NO.	SHEET NO.
	U-5105	X-7

75 70 65 60 55 50 45 40 35 30 25 20 15 10 5 0 5 10 15 20 25 30 35 40 45 50 55 60 65 70 75

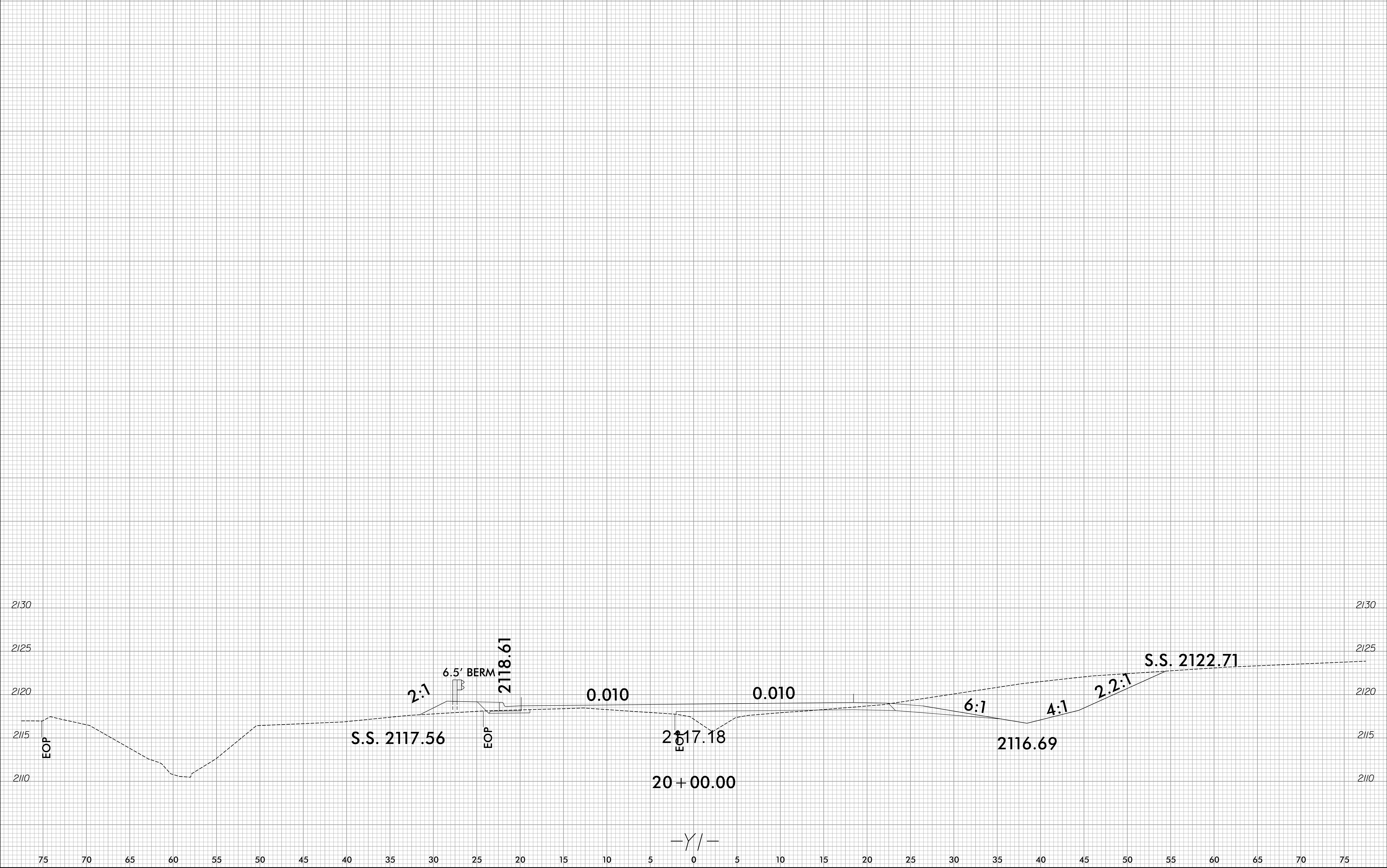

2/14/2018
 H:\Roadway\XSC\U5105_r.dwg -xp1_Y1.dgn
 gwilliams

75 70 65 60 55 50 45 40 35 30 25 20 15 10 5 0 5 10 15 20 25 30 35 40 45 50 55 60 65 70 75

8/23/99

0 5 10	PROJ. REFERENCE NO.	SHEET NO.
	U-5105	X-8

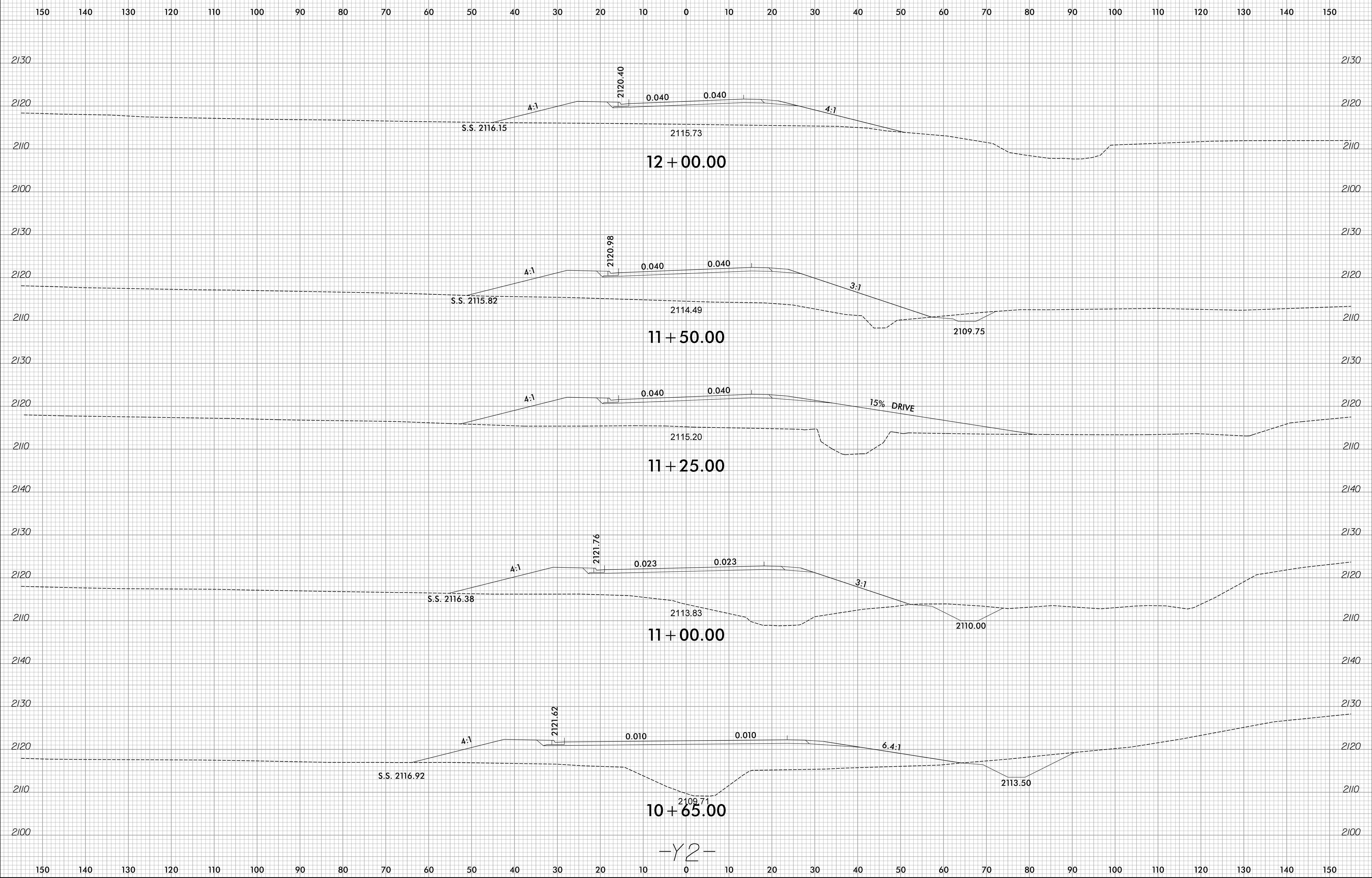

2/14/2018
R:\Roadway\XSC\U5105_r.dwg - xpl.y2.dgn
gwilliamson

-Y2-

8/23/99

0 5 10	PROJ. REFERENCE NO.	SHEET NO.
	U-5105	X-9

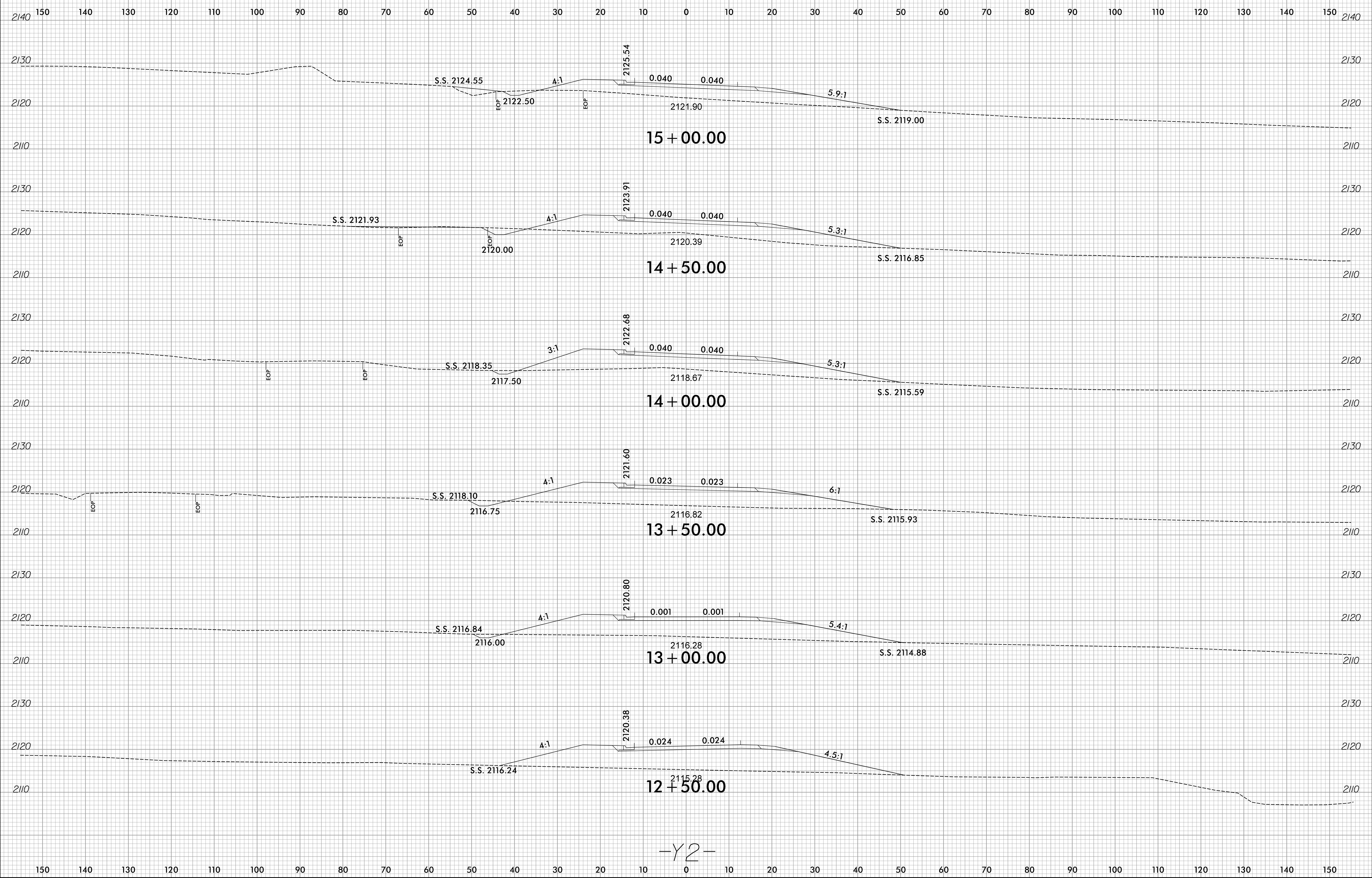

-Y2-

2/14/2018
R:\Roadway\XSC\U5105_r.dwg - xpl.y2.dgn
awilliamson

8/23/99

0 5 10	PROJ. REFERENCE NO.	SHEET NO.
	U-5105	X-10

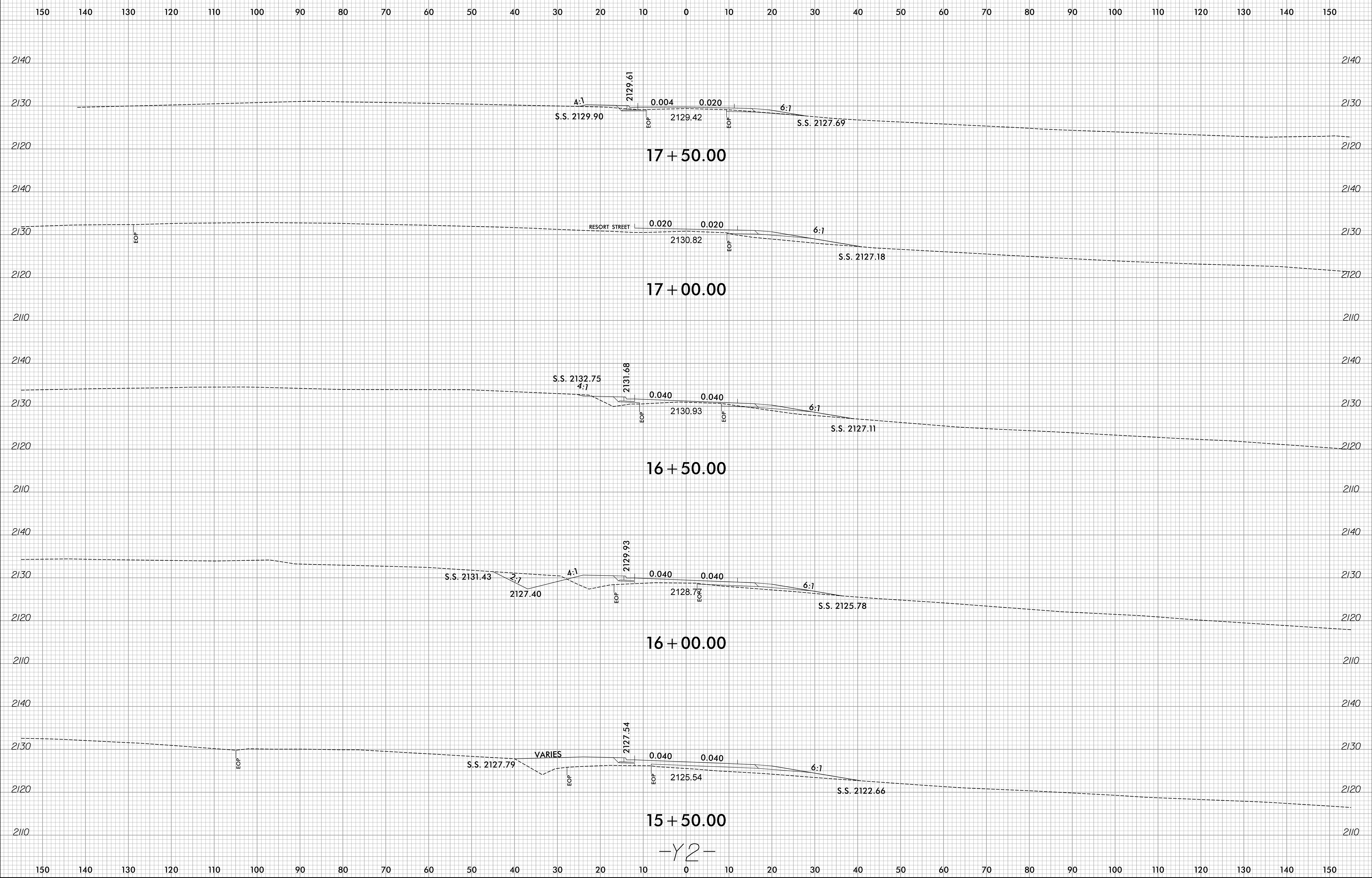

2/14/2018
R:\Roadway\XSC\U5105_r.dwg -xp1_y2.dgn
Bill Johnson

8/23/99

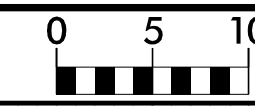

PROJ. REFERENCE NO.
U-5105

SHEET NO.
X-11

150 140 130 120 110 100 90 80 70 60 50 40 30 20 10 0 10 20 30 40 50 60 70 80 90 100 110 120 130 140 150

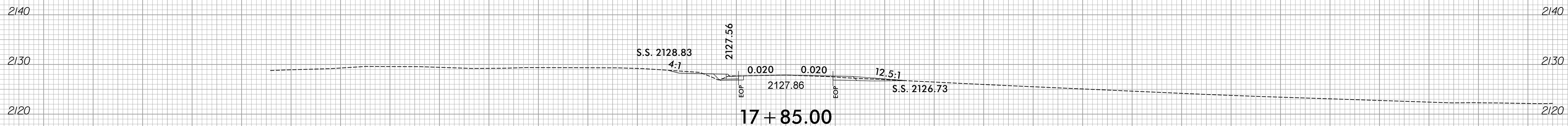

-Y2-

150 140 130 120 110 100 90 80 70 60 50 40 30 20 10 0 10 20 30 40 50 60 70 80 90 100 110 120 130 140 150

2/14/2018
R:\Roadway\XSC\U5105_r.dwg - xpl - Y2.dgn
gwilliamson

8/23/99

0 2.5 5	PROJ. REFERENCE NO.	SHEET NO.
	U-5105	X-12

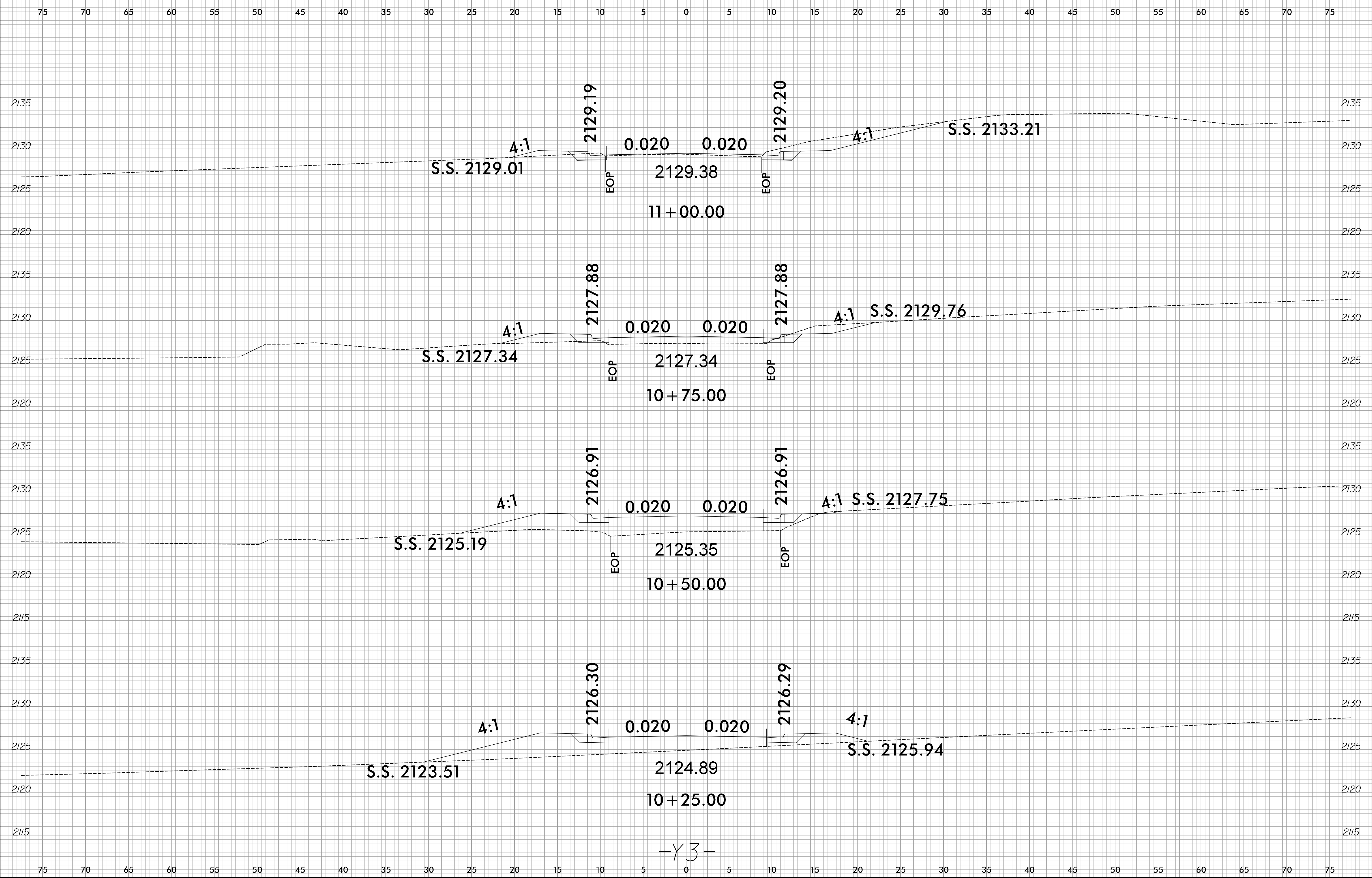

-Y3-

2/14/2018
R:\Roadway\XSC\U5105_r.dwg - xpl_Y3.dgn
Bill Hanson

8/23/99

0 2.5 5	PROJ. REFERENCE NO.	SHEET NO.
	U-5105	X-13

75 70 65 60 55 50 45 40 35 30 25 20 15 10 5 0 5 10 15 20 25 30 35 40 45 50 55 60 65 70 75

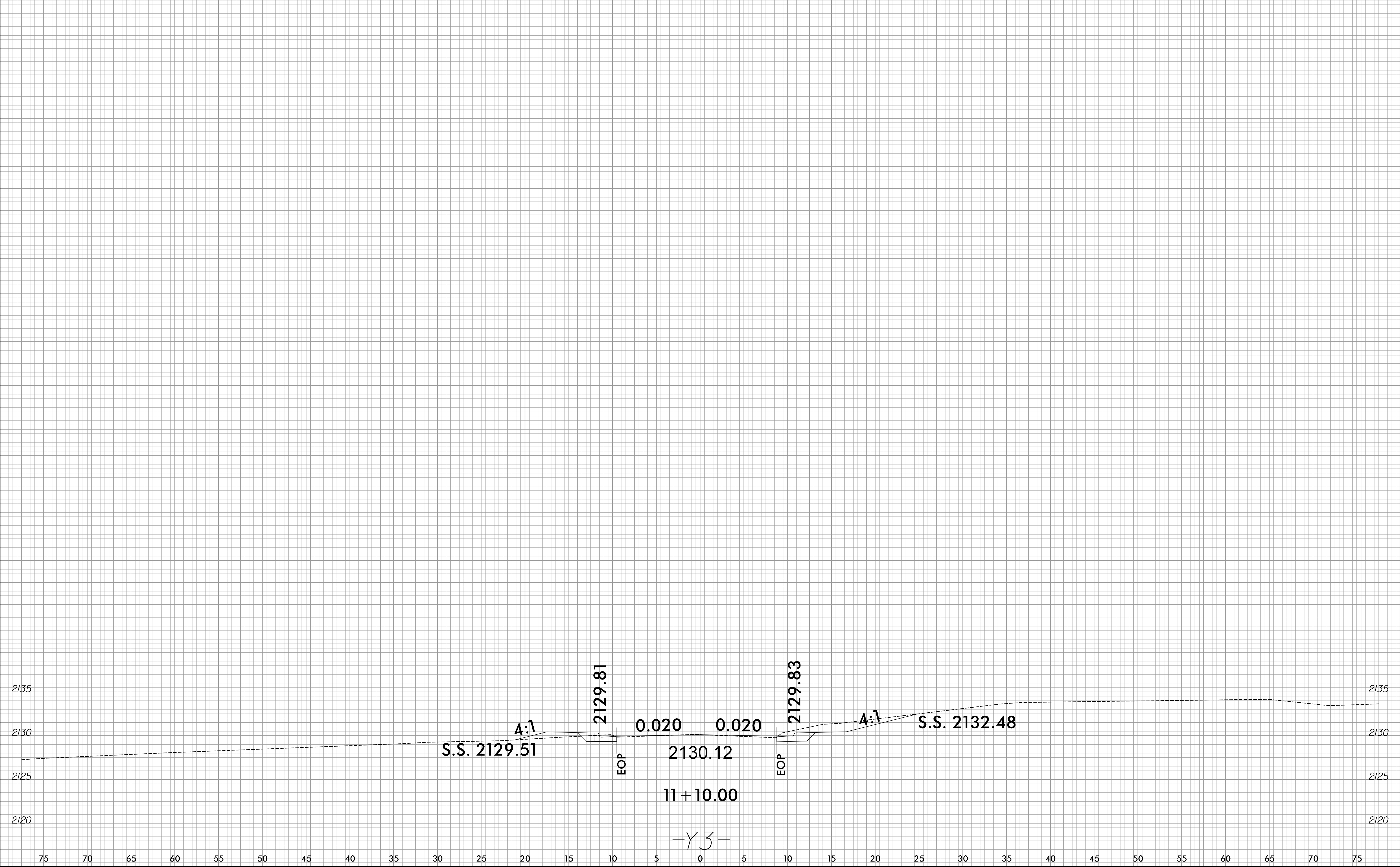

2/14/2018
 H:\Roadway\XSC\U5105_r.dwg - xpl - Y3.dgn
 gwilliamson